



# Solid Flange Sill-Faucet 255 & 355



Base Model #	Description
255	1/2" FIP x 3/4" Hose Connection
355	3/4" FIP x 3/4" Hose Connection

### Features

- ▶ Heavy Duty Red Brass Construction (83% Copper)
- ▶ No-Leak O-Ring Bonnet & Stem (no packing nut)
- ▶ Green Tee Handle; Also available with Wheel Handle (WH Models) or Oval Handle (OH Models)
- ▶ Maximum Pressure: 125 PSI
- ▶ Maximum Operating Temp 180° F
- ▶ 8-9 GPM Flow Rate
- ▶ 3 Year Limited Warranty
- ▶ Made in USA with domestic and foreign components
- ▶ Available Options: Loose Key (LK); Vacuum Breaker (BFP); QuickTurn® (QT)
- ▶ Available Finishes: Rough Brass; Nickel/Satin (SAT); Polished Chrome (CHR)

### Dimensions

Model	Height	Width	Depth	Weight
255	3.5"	1.25"	3.5"	0.45 lbs
355	3.5"	1.25"	3.5"	0.47 lbs

Loose Key  
255LK



Anti-Siphon  
255BFP



QuickTurn®  
255QT





### Repair Parts & Part Kits

Part #	Description
PK1250	Green Wheel Handle (9) & Screw (8)
PK1100	O-Ring Seal One-Piece Bonnet Stem Assembly
5	Seat Washer
6	Seat Washer Screw- Stainless Steel
8	Handle Screw- Stainless Steel
7	Nylon Bonnet Washer
10	Green Tee Handle 12 pt broach- Aluminum
<i>Add On/Options</i>	
PKQTASSY	QuickTurn® Stem & Bonnet Assembly, Lever Handle & Screw
58ABP	Add-On Vacuum Breaker
PK1150	Loose Key Stem & Lock Shield Assembly
23	Loose Key

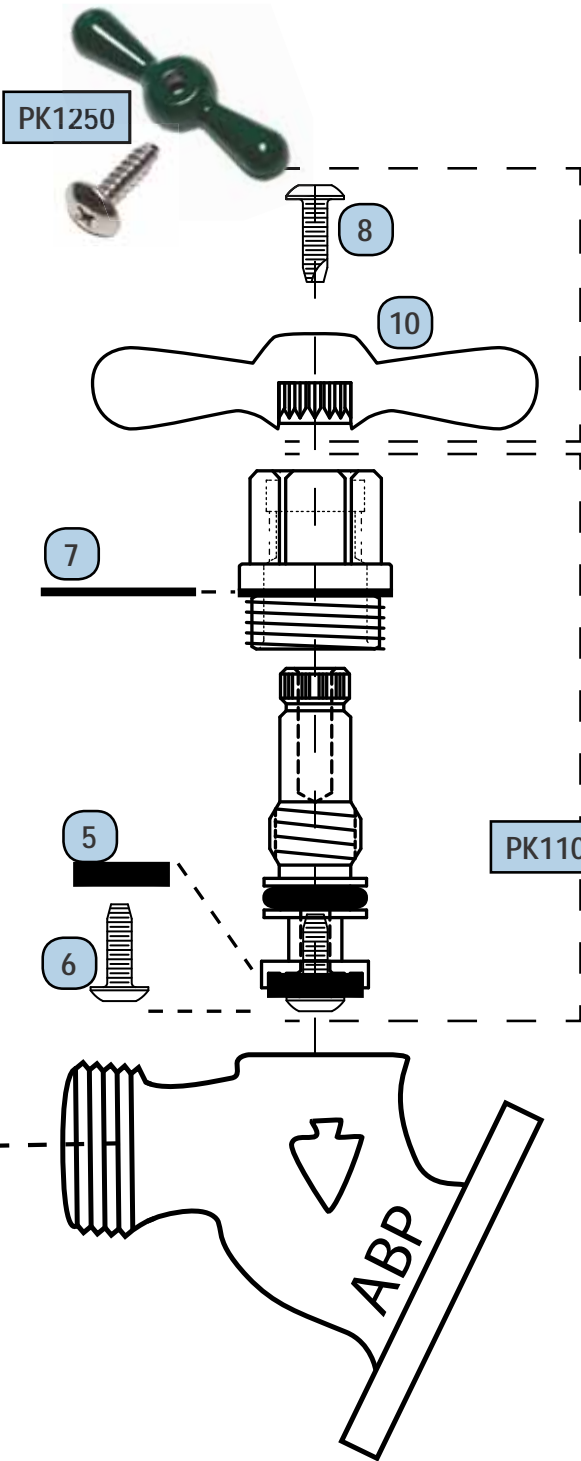

PK1100



PK1100



58ABP



PK1150

23



**ILLEGAL TO USE FOR POTABLE (DRINKING) WATER**  
 Prop 65 Warning: This product contains lead compounds or other chemicals known to the State of California to cause cancer, birth defects or other reproductive harm.

5147 Alhambra Ave. ▼ Los Angeles ▼ CA ▼ 90032  
 P. 323.221.9137 ▼ F. 323.221.2579 ▼ [www.arrowheadbrass.com](http://www.arrowheadbrass.com)