

For Residential and Commercial Applications

Job Name	Engineer / Architect
Job Location	Wholesaler
Submittal Date	Contractor

Product Submittal Form

P1-**DL/ P3-**DL PEX Toilet Riser - One-Piece with Compression Sleeve or Insert

Use: For use in potable water distribution systems in accessible locations only

Design Features:

- **One-piece construction**
- **Cut-to-Length** for a clean, professional installation
- **100% Compliant** to California and Vermont "low-lead" requirements

Operating Specifications:

Temperature: 40° - 180° F
Pressure: 125 psi maximum

Tubing Diameter: 0.375" O.D. or 0.50" O.D.



MATERIAL SPECIFICATIONS	
Tube	Cross-linked Polyethylene (PEX)
Compression Sleeve (3/8"OD)	POM
Compression Insert (1/2"OD)	Stainless steel

PART DIMENSIONS (Inches)		
Model	DIM. A	DIA. B
P1-12DL	11.56	.38
P1-15DL	14.56	.38
P1-20DL	19.56	.38

PART DIMENSIONS (Inches)		
Model	DIM. A	DIA. B
P3-15DL	14.56	.50
P3-20DL	19.56	.50

Part Listing:

- P1-12DL 3/8" OD Tube x 11-1/2" Length
- P1-12DL F 3/8" OD Tube x 11-1/2" Length, flag label
- P1-15DL 3/8" OD Tube x 14-1/2" Length
- P1-20DL 3/8" OD Tube x 19-1/2" Length
- P1-20DL F 3/8" OD Tube x 19-1/2" Length, flag label
- P3-15DL 1/2" OD Tube x 14-1/2" Length
- P3-20DL 1/2" OD Tube x 19-1/2" Length
- P3-20DL F 1/2" OD Tube x 19-1/2" Length, flag label

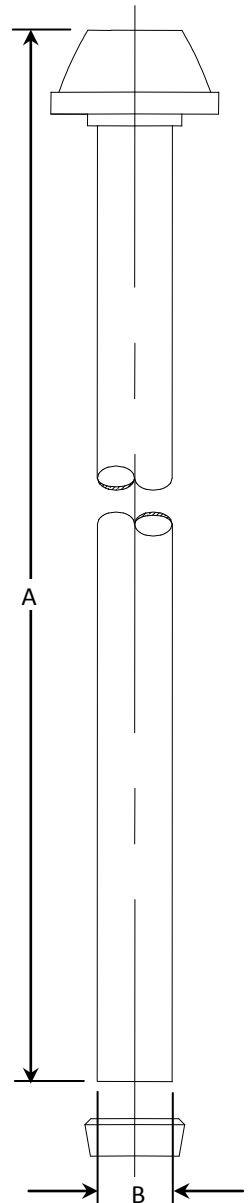

Listings & Certifications:

- IAPMO listed to ASME A112.18.1 - 2005/CSA B125.1-05 (File # 0645)
- CSA approved to California Health & Safety Code and Vermont Bill S.152 (Project # 2174785)
- MerFlex PEX listed by NSF to ASME A112.18.6, CSA B125, CSA B137.5 and U.P. Code



This specification and all information contained herein is the confidential and exclusive property of BrassCraft Manufacturing, and shall not be disclosed to others without the written consent of BrassCraft. This specification must be returned to BrassCraft if requested.

BrassCraft®